

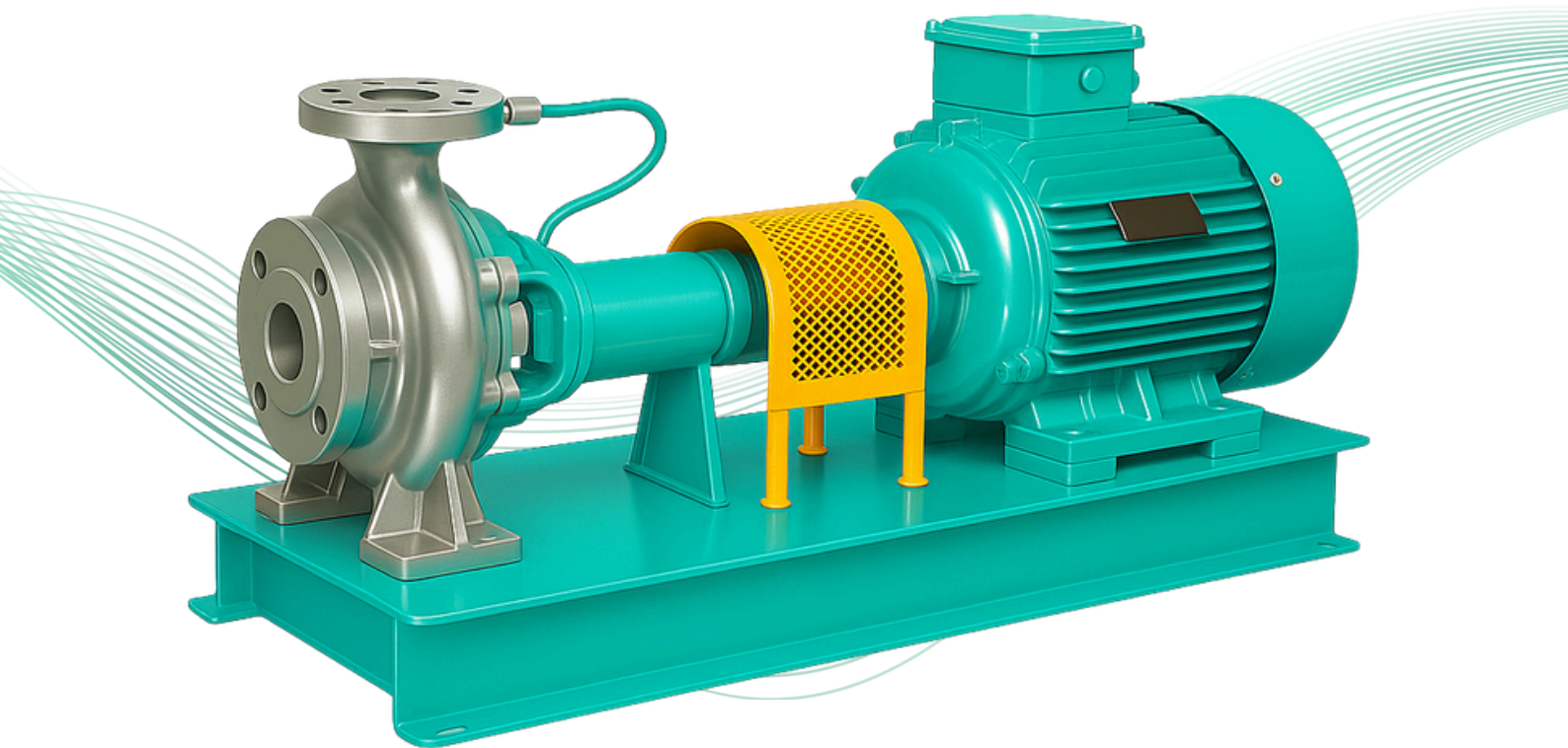

TranspumpServ  
GLOBAL PVT LTD

# ChemNorm (TchemX)

Centrifugal pumps according to ISO 5199 and ISO 2858 / EN 22858 (DIN 24256)



## ChemNorm Inherent Reliability!

- The TRANSPUMPSERV ChemNorm series features a modular architecture, comprising single-stage centrifugal pumps with a high level of component interchangeability. This design enables flexibility, efficiency, and streamlined maintenance across diverse pump configurations.
- The ChemNorm pump series encompasses a wide range of centrifugal pumps, available in horizontal, vertical, and submerged configurations. Designed with adherence to multiple industry standards, including: EN 733 (DIN 24255), EN 22858 (ISO 2858 / DIN 24256), ISO 5199, API 610.

**ChemNorm, a flagship product from TRANSPUMPSERV GLOBAL PVT LTD, is a modular system of single-stage centrifugal pumps designed for the chemical industry.**

## Key features include:

- **Modular Design:** High interchangeability of parts between pump constructions
- **ISO-Compliant:** Designed to ISO 2858/EN 22858 (DIN 24256) and ISO 5199 standards
- **Versatile:** Suitable for handling low-viscosity, clean or slightly contaminated liquids
- **Wide Range of Options:** Various shaft sealings, bearing constructions, and materials (stainless steel, bronze, nodular cast iron, cast iron)
- **Leak-Free Option:** TMag magnetic coupled centrifugal pump for chemical industry applications



# Application Scope :-

## Turning Know-How into Innovative Solutions



### Industrial Sector:-

The ChemNorm is engineered to meet the demanding needs of chemical industries, with a design that fully complies with the ISO 5199 standard. This ensures that the pump's technical specifications align with the requirements of ISO 2858/EN 22858 (DIN 24256), making it an ideal choice for chemical processing applications.

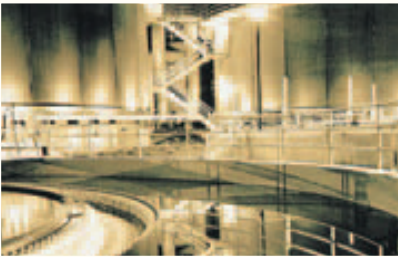

### Utility:-

TchemX durable design, versatile materials, and flexible sealing options make it a dependable pump for general industry applications. Its adherence to international standards (ISO 2858, ISO 5199, and EN 22858/DIN 24256) guarantees optimal performance and reliability.

## Product Advantages

1. **Standard Seals: EN 12756 (DIN 24960) compliant**
2. **Seal Flexibility: Single and double cartridge seals**
3. **Wide Application Range**
4. **Multi-Material Options**
5. **Reduced Inventory: 4 bearing brackets for the whole range**
6. **Easy Maintenance: Back Pull Out principle**
7. **Customizable Covers: Cylindrical and tapered bore options**

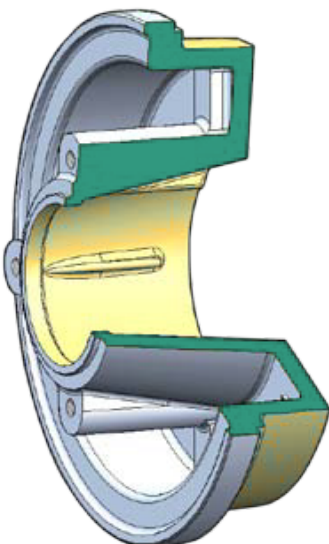
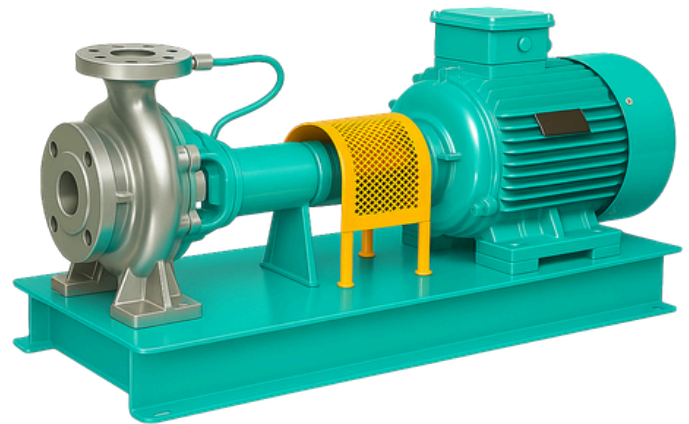

## Enhanced Mechanical Seal Life:-

The ChemNorm pump features a conical seal chamber that improves seal durability by diverting abrasive materials and enhancing heat dissipation. The ribbed chamber design also eliminates vortex formation, contributing to increased seal reliability and lifespan.

## Enhanced Pump Performance:-

- Streamlined Volute Design
- Smooth Surface Finish
- Minimized Internal Losses
- High-Efficiency Performance

## Flexible Material Options:-

Our pump is crafted from various materials to suit your needs:

- Standard options: Cast Iron, Nodular Cast Iron, Bronze, and Stainless Steel
- Special request option: Duplex

## Optimized Suction Performance:-

- Smooth suction entry
- Optimal NPSH values
- Anti-rotation vane for stable flow
- Low turbulence surfaces
- Reduced flow distortion

## Robust Pump Casing:-

- Standardized Flanges: ISO 7005 PN 16 or PN 20 (equivalent to ANSI B16.5 150 lbs)
- High Working Pressure: Up to 16 bar
- Versatile Applications: Suitable for a wide range of uses
- Efficient Drainage: Large drain opening for complete and fast draining of the casing

## Impeller Fastening:-

- Stainless Steel Cap Nut: Durable and corrosion-resistant
- Flat Gasket: Ensures a tight seal
- Reliable Locking: Securely fastens the impeller in place

## Impeller Back Vane Benefits:-

- Improved Seal Performance through circulation flow
- Extended Bearing Life through reduced load
- Protection of Shaft Seal by keeping solids away

## Stable Foot Mounting:-

- Machined for Precision
- Accurately Positioned on the baseplate and in pipework for stable operation

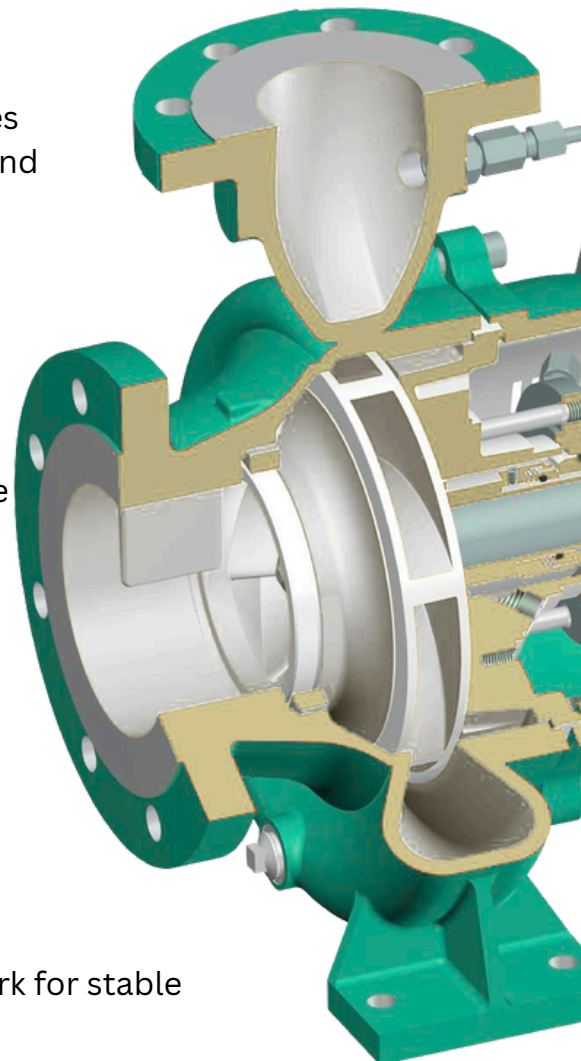

## Robust Shaft Design:-

- High-Quality Materials: Stainless steel or steel alloy for strength and durability
- Precise Design: Minimal shaft deflection (0.05 mm) near the seal, extending seal life
- Shaft Sleeve: Ensures co-rotation of the shaft with the impeller
- Dry Shaft: Designed to prevent contact with the pumped liquid, reducing maintenance needs

## Versatile Shaft Sealing Options:-

- Multiple Mechanical Seal Options: 7 EN-seal and cartridge seal choices
- Customizable Sealing: Various combinations of sealing rings and elastomers
- Quench and Flush Connections: Integrated into the sealing cover
- Gland Packing Options: 3 configurations, including cooling cover
- Wide Applicability: Suitable for diverse applications, liquids, and high temperatures
- Tapered Bore Seal Chamber: With or without flush plan, ensuring optimal sealing performance

## Reliable Oil Lubrication System:-

- Oil Bath Lubrication for smooth operation
- Constant Level Oiler for consistent lubrication
- Convenient Breather/Filling Plug for maintenance
- Oil Sight Glass for easy monitoring
- Large Drain Plug for easy oil changes

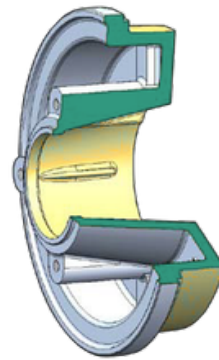

Tapered bore seal chamber option

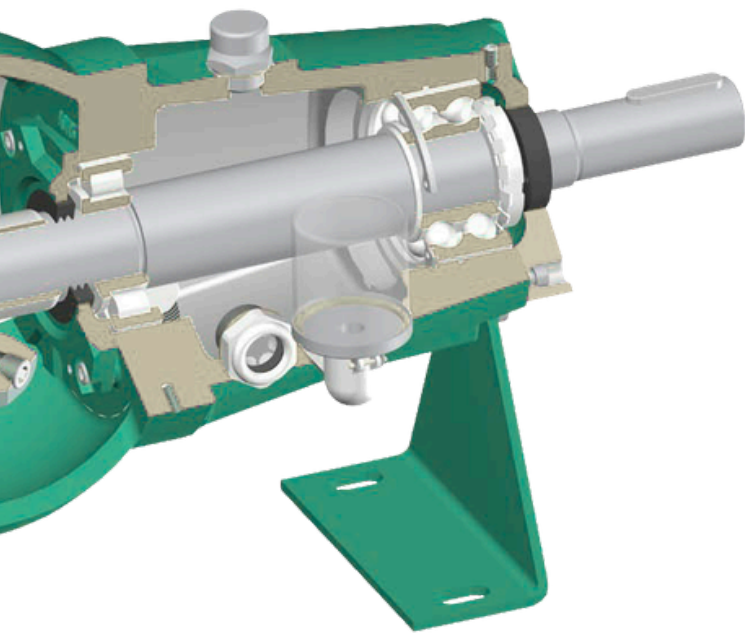

## Robust Bearing Design:-

- Extended Bearing Life: 17,500 hours or more across the Q-H curve
- Reliable Lubrication: Oil bath or grease lubrication options
- Secure Bearing Lock-up: Shaft nut with lock washer ensures stability
- Rigid Bearing Bracket: Cast iron construction minimizes bearing movement
- Adjustable Clearances: For half-open impeller and wear plate, ensuring optimal performance

## Easy Maintenance Features:-

- Quick and Easy Maintenance through Back Pull Out principle
- Reduced Downtime for impeller replacement and seal maintenance
- Cost-Effective through reduced maintenance costs and longer-lasting components
- Easy-to-Replace Parts (cartridge seals, wear rings)
- Standardized Mechanical Seals (EN 12756/DIN 24960) for ease of replacement

## Advanced Pump Cover Design:-

- Secure Gasket System (flat gasket, fully chambered) to prevent blow-outs
- Tapered Bore Seal Chamber with flow-guiding ribs for optimal seal performance
- Improved Heat Dissipation for extended seal life
- Machined Fits for precise alignment
- Integrated Seal Chamber (stuffing box/mechanical seal) with cylindrical bore

## Technical Data:-

Max. capacity

:-800 m<sup>3</sup>/h

Max. head

:-160 m

Max. working pressure

:-1600 kPa (16 bar)

Max. temperature

:-50 °C up to +200 °C

Max. speed

:-3600 rpm

## Hydraulic Performance Data:-

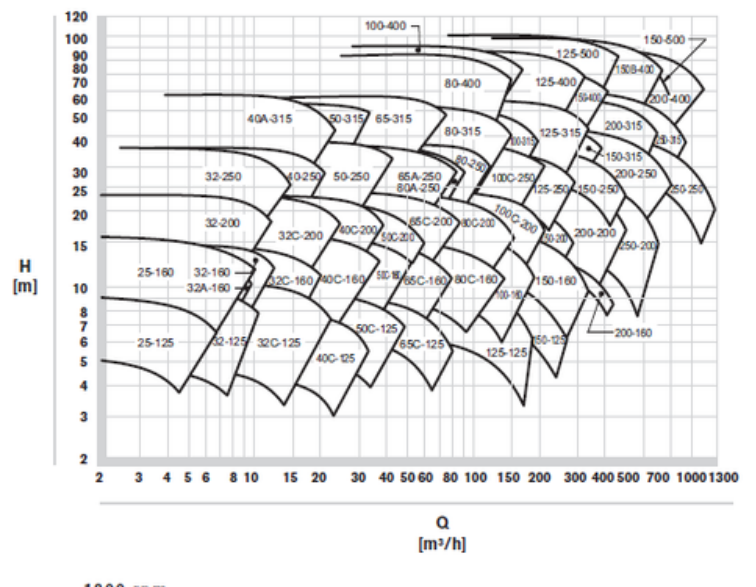
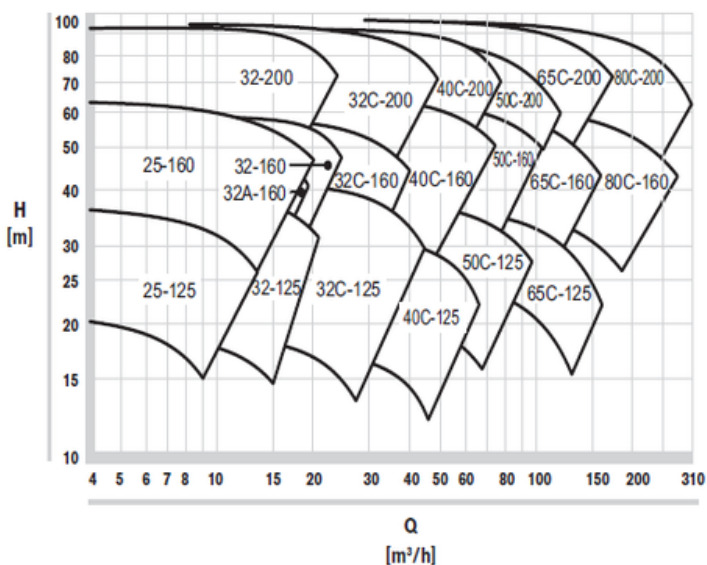
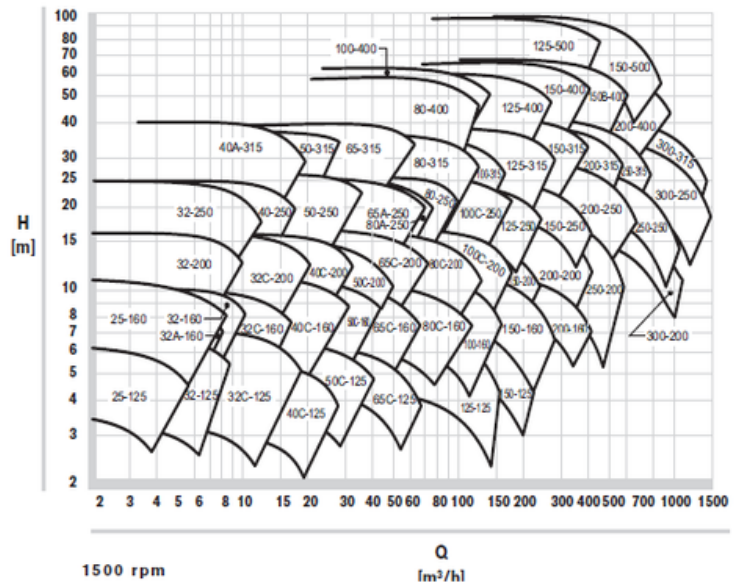
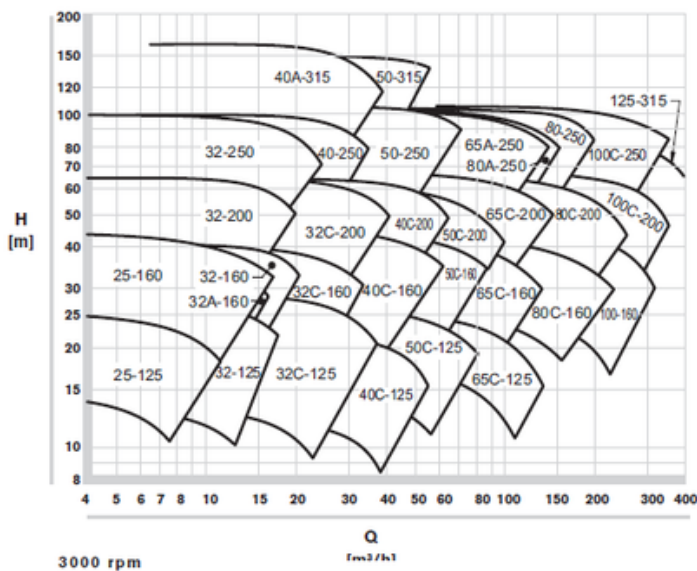



# ChemNorm:-

## Bearing The ChemNorm has 2 bearing

1. two deep-groove ball bearings (grease lubricated “sealed for life”) Centrifugal pump according to EN 733 (DIN 24255)
2. a double-row (two single – bearing group 4) angular contact ball bearing in combination with a roller bearing

Both versions can be provided grease lubricated as well as oil lubricated.

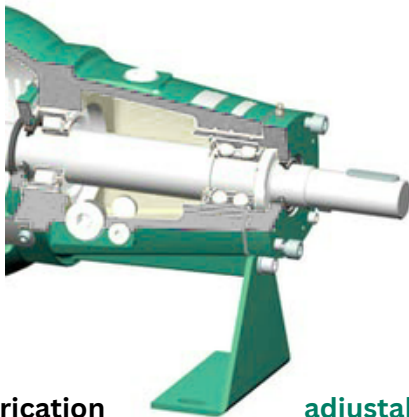

Grease lubrication

adjustable

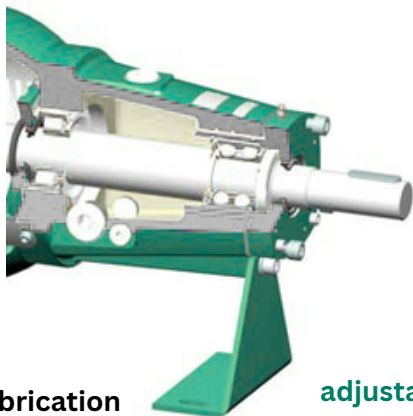
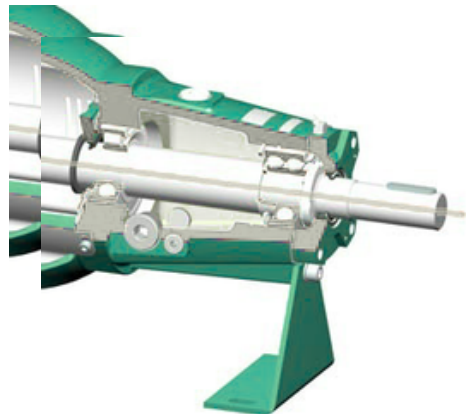

Oil lubrication

adjustable

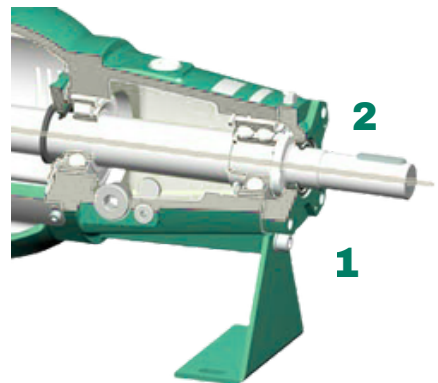



# TranspumpServ

GLOBAL PVT LTD

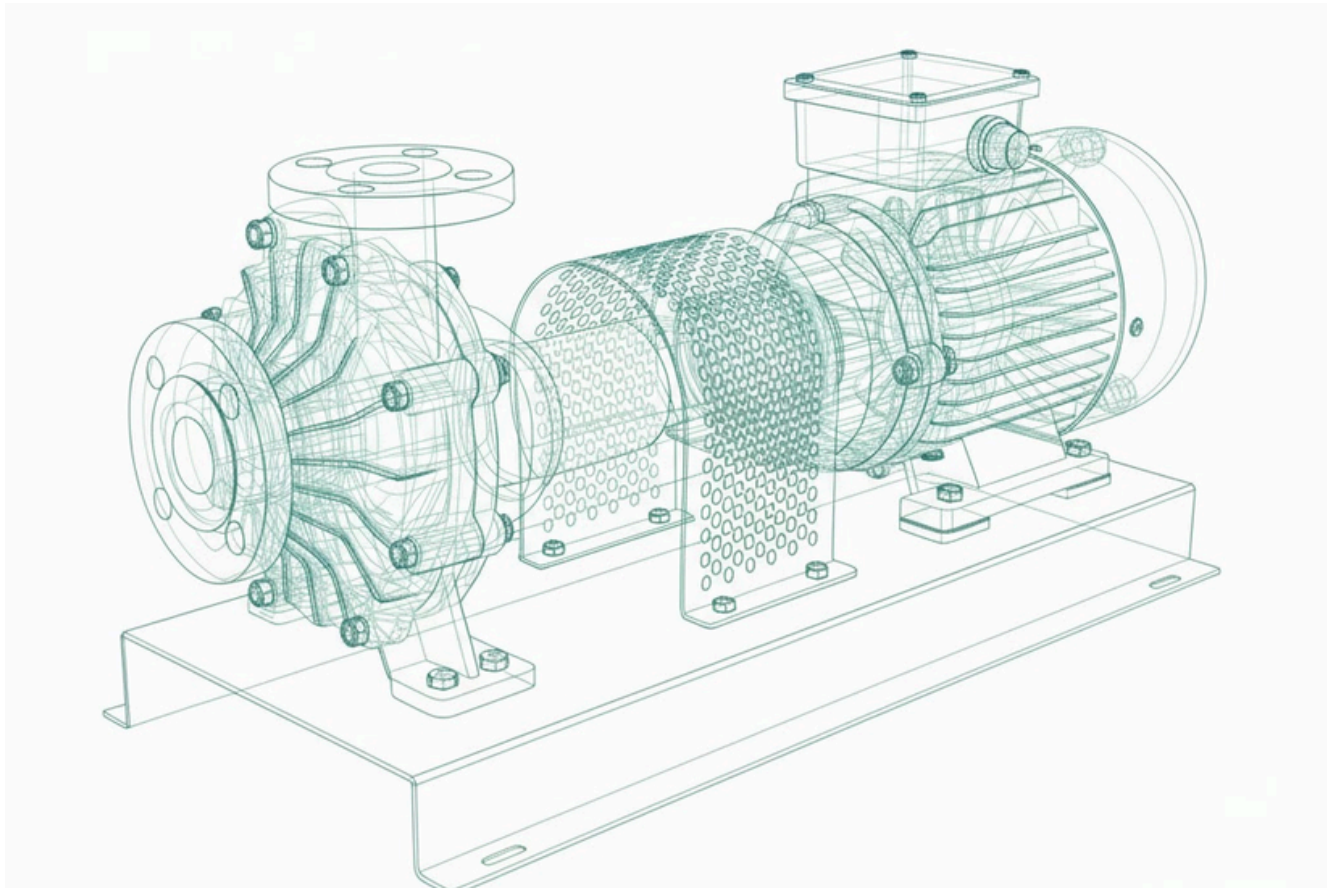

## India

**Transpumpserv Global (HQ)**

📍 Vadodara – Gujarat, INDIA

**Transpumpserv Engineering  
(Mfg. Unit-1)**

Valod – Surat, INDIA

☎ + 91 92136 11384



## Canada

**Transpumpserv Alberta Inc.**

📍 Manulife Place,  
3400 – 10180 101 St NW  
Edmonton, Alberta T5J 3S4  
Canada

☎ +1 (780) 695-3232

Follow Us :   

✉ [info@transpumpservglobal.com](mailto:info@transpumpservglobal.com)

🌐 [www.transpumpservglobal.com](http://www.transpumpservglobal.com)